

OFFICE OF CROWN LANDS

Your Reference:

Our Reference: 92/25/0/12:695050



246 St Hill Street
P O Box 4017
Wanganui
New Zealand
Phone: 06 345-0911
Fax: 06 345-3282

9 June 1993

The District Land Registrar
Land Registry Office
WELLINGTON

GN B294899.1 Gazette N

Copy - 01/01, Pgs - 006, 12/03/14, 12:34

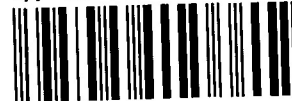

DocID: 412177327

TONGARIRO POWER DEVELOPMENT : RANGIPO NORTH 5C, 6C

I enclose for deposit in your office a Gazette Notice of 10 January 1991, page 12, amended on 31 January 1991, page 338, which acquired for the generation of electricity areas of freehold land of Deeds Index 37/25, and a right of way over other land.

This document was lodged on dealing B.149721 on 18 March 1991 and rejected - a copy of your reasons is attached - and I entirely agree that applies to the right of way land which has been transferred by the Maori Land Court back to Maori ownership by an order which cannot yet be registered. However, I submit that there is no reason why the Notice cannot be registered in respect of the land in the First Schedule, and this document is lodged for that to occur.

Will you kindly register the document against all lands affected thereby, inform me when this has been done, and advise the number allotted to the document.

If you find the document doubtful or incorrect in any respect, will you please refrain from registering and inform me at once, giving due consideration to section 56 of the Public Works Act 1981 before rejecting the document.

B P BONISCH
District Solicitor

Encl

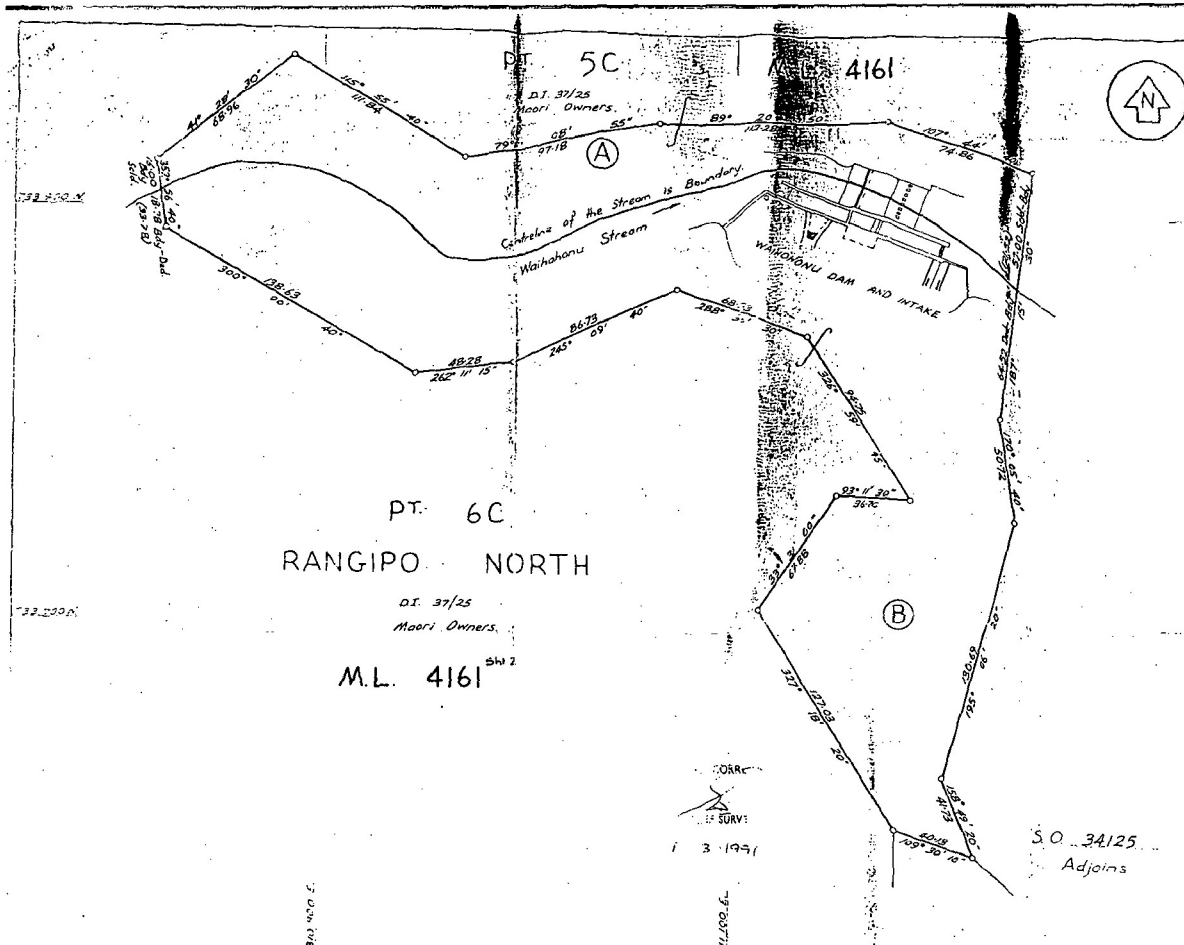

Approved as to layout.
 PROJECT ENGINEER
 DATE

SCHEDULE OF AREAS
 LAND TO BE TAKEN
 FOR GENERATION OF ELECTRICITY

SHOWN	TITLE REF	DESCRIPTION	AREA
A	D.T. 37/25	PT. Rangipo North 5C - Blk III Kaimanawa S.D.	16844 ha.
B	D.T. 37/25	PT. Rangipo North 6C - Blk III Kaimanawa S.D.	42356 ha.

Total Area 59200 ha.
 Comprised in D.T. 37/25

Station 5470 229-244 210 245-249
 Approved by S. R. Jolly
 Date 17 2 85

S.O. 34125
 Adjoins

WELLINGTON
 DIST. OF KAMANAWA
 SHEET NO. T20-4-1

PARTS 5C AND 6C
 RANGIPO NORTH

LOCAL AUTHORITY TAupo COUNTY
 Surveyed by S. R. Jolly
 Scale 1:1250
 Date JULY 1984

S034124

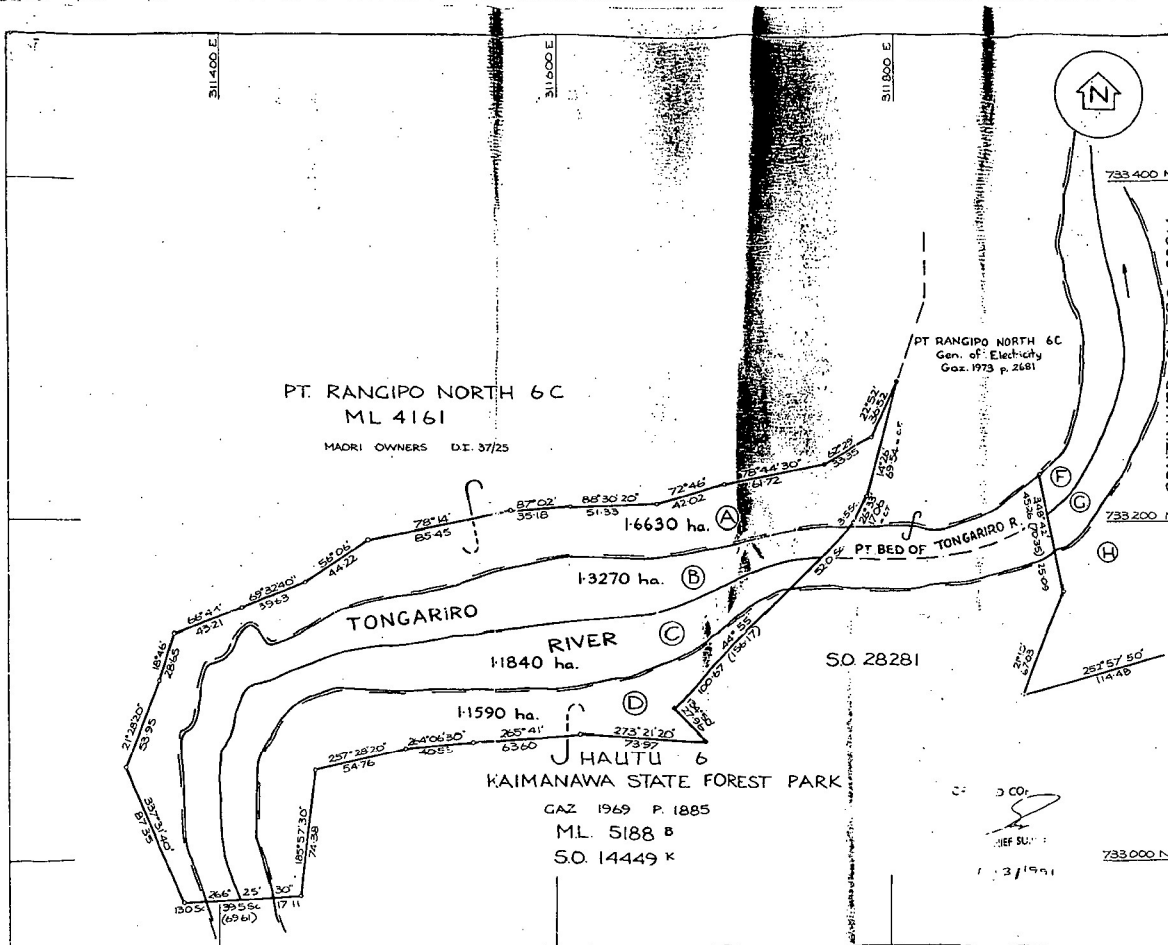

APPROVED, AS TO LAYOUT

PROJECT ENGINEER: *[Signature]* DATE: *[Blank]*

SCHEDULE OF AREAS
LAND TO BE TAKEN FOR POWER PURPOSES

Shown	Title Ref	Description	Area
A	PL. DI. 37/25	PT. RANGIPO NORTH 6C	1:6630 ha.
B		PART BED OF TONGARIRO RIVER	1:3270 ha.
C		PART BED OF TONGARIRO RIVER	1:1840 ha.
D	GOV. 1969 P. 1885/1	PART HAUTU 6	1:1590 ha.
			5:3330 ha.

Total Area 5:3330 ha.
Comprised in PT. DI. 37/25, GAZ. 1969 P. 1885/1

I, KEITH FRANCIS KNARSTON of TURANGI Registered Surveyor and holder of an annual practicing certificate hereby certify that this plan has been made from surveys conducted by me or under my direction; that both plan and survey are correct and have been made in accordance with the regulations under the Surveyors Act 1986.

Dated at TURANGI this 20th day of MAY 1982. Signature: *[Signature]*

Field Book 5282, p. 214-239. Traverse Book 207, p. 19-24. Reference Plans SO14449, SO28251, SO32759, ML 4161, ML 5188 B, S.O. 32262, S.O. 31514. Estimated Height Correc. *[Signature]*

Approved as to Survey *[Signature]* (Chief Surveyor)

31 8 82 Deposited this day of *[Blank]*

District Land Registrar

File 11/419
Received 31-5-82
Instructions

S033313

LAND DISTRICT WELLINGTON
SURVEY BLK. & DIST. III KAIMANAWA
NZMS 261 SHEET NO. T20/4-1, 5-1

PT. RANGIPO NORTH 6C, PT. HAUTU 6
AND BED OF TONGARIRO RIVER

LOCAL AUTHORITY TAUPO COUNTY
Surveyed by K.F. KNARSTON (M.W.D.)
Scale 1:1500 Date MAY 1982

Extract from *N.Z. Gazette*, 31 January 1991, No. 17, p. 338

**Amending a Notice Acquiring Land and Easement
for the Generation of Electricity in Taupo District**

Pursuant to section 55 of the Public Works Act 1981, and to a delegation from the Minister of Lands, the District Solicitor, Department of Survey and Land Information, Wanganui, hereby amends the notice dated the 3rd day of January 1991, and published in the *New Zealand Gazette* of 10 January 1991, No. 1, at page 12, declaring land and easement to be acquired for the generation of electricity, by omitting from the penultimate line thereof the words "District Surveyor" and substituting therefor the words "District Solicitor".

Dated at Wanganui this 18th day of January 1991.

B. P. BONISCH, District Solicitor.

(DOSLI Wg. 92/25/0/12 : 695105)

ICL

In808

Extract from *N.Z. Gazette*, 10 January 1991, No. 1, p. 12

Land and Easement Acquired for the Generation of Electricity in Taupo District

Pursuant to section 20 of the Public Works Act 1981, and to a delegation from the Minister of Lands, the District Solicitor, Department of Survey and Land Information, Wanganui, declares that, agreements to that effect having been entered into, the land described in the First Schedule hereto, and the easement described in the Second Schedule hereto, are acquired for the generation of electricity and vested in the Crown on the date of publication hereof in the *Gazette*.

First Schedule

Wellington Land District—Taupo District

Land Acquired

All those pieces of land situated in Block III, Kaimanawa Survey District, described as follows:

Area ha	Being
1.6844	Part Rangipo North 5C; marked "A" on S.O. Plan 34124.
1.6630	Part Rangipo North 6C; marked "A" on S.O. Plan 33313.
4.2356	Part Rangipo North 6C; marked "B" on S.O. Plan 34124.

As shown marked as above mentioned on the plans above mentioned, lodged in the office of the Chief Surveyor at Wellington.

Second Schedule

Wellington Land District—Taupo District

Easement Acquired

The "right of way" as such expression is defined in the Seventh Schedule to the Land Transfer Act 1952 over the land described as follows:

Area ha	Being
9.4266 (23a1r7p)	Part Rangipo North 3C; coloured blue on S.O. Plan 27964. = Proc 968709
4.3494	Part Rangipo North 4C; marked "B" on S.O. Plan 33385.
6.3270	Part Rangipo North 4C; marked "C" on S.O. Plan 33386.
m ²	
4648	Part Rangipo North 6C; marked "B" on S.O. Plan 30546. - CN 432939
ha	
1.0017	Part Rangipo North 6C; marked "A" on S.O. Plan 34125.

All situated in Block XV, Pihanga Survey District.

As shown marked and coloured as above mentioned on the plans above mentioned, lodged in the office of the Chief Surveyor at Wellington.

Dated at Wanganui this 3rd day of January 1991.

B. P. BONISCH, District Surveyor.

(DOSLI Wg. 92/25/0/12:695105)

In58

9646102.1 - CIR 648666 issued
for the land described in the
First Schedule herein - 18.2.2014
at 7.00 am

L. E. Roe
for RGL

RECALL FILE LABEL
F5000013335832

2. U. S. ...

SKINNER

Deeds Index

37/25 (pg. 173)

10000 15.0-43
D 05 21

Registered as to the first schedule only
see attached letter